

PRE-INCIDENT SURVEY

Building Name: AAA Cooper Transport Survey #: 63
 Street Address: 2503 W. 5th St.
 City, State, Zip: _____
 Primary Use: terminal Construction Type: Metal
 Possible Entry: _____
 Possible Occupancy: A.M. 2-1pm to 10pm P.M. 1-8 to 5
 Known Handicapped Personnel: 1 - 230 AM to 12pm

NOTIFY IN CASE OF EMERGENCY

Name: Lydia Borganus Name: Bill Cherry
 Phone: 258~~44~~-8149 Phone: 945 6133
975-1155

BUILDING CONSTRUCTION

Roof Type: Metal Floor Construction: Slab
 Roof Construction: Metal
 Basement Construction Type: _____ Height of Basement: _____
 Number of Stories: 1 Height of Each Story: _____
 Length: _____ Width: _____ Height: _____
 Attic Area: _____ Size: L _____ X W _____ X H _____

UTILITY TYPES

Gas: _____ Type: _____
 Gas Shut Off Valve Location: _____
 Electric: Wash Utility Phase: _____
 Panel Location: _____
 Alarm Location: _____

EXPOSURES

North: _____ FT. West: _____ FT. South: _____ FT. East: _____
 Type: _____ Type: _____ Type: _____ Type: _____



© 2014 Google

Google earth

Google earth

feet
meters

10

4



SUPPRESSION CRITERIA

Needed Fire Flow: _____ Total Water Supply: _____

Fuel Load: _____ Rate of Flow: _____

HYDRANT LOCATIONS

(1) _____ Flow: _____ Unit: _____

(2) _____ Flow: _____ Unit: _____

(3) _____ Flow: _____ Unit: _____

(4) _____ Flow: _____ Unit: _____

OTHER WATER RESOURCES

(1) _____

(2) _____

(3) _____

SPECIAL RESOURCES

(1) _____

(2) _____

(3) _____

MUTUAL AID

(1) _____ Assignment: _____

(2) _____ Assignment: _____

(3) _____ Assignment: _____

STAGING AREA

Primary: _____

Secondary: _____

MISCELLANEOUS INFORMATION

Sprinkler Connection: _____

Standpipe Connection: _____

Diesel - in ground tank

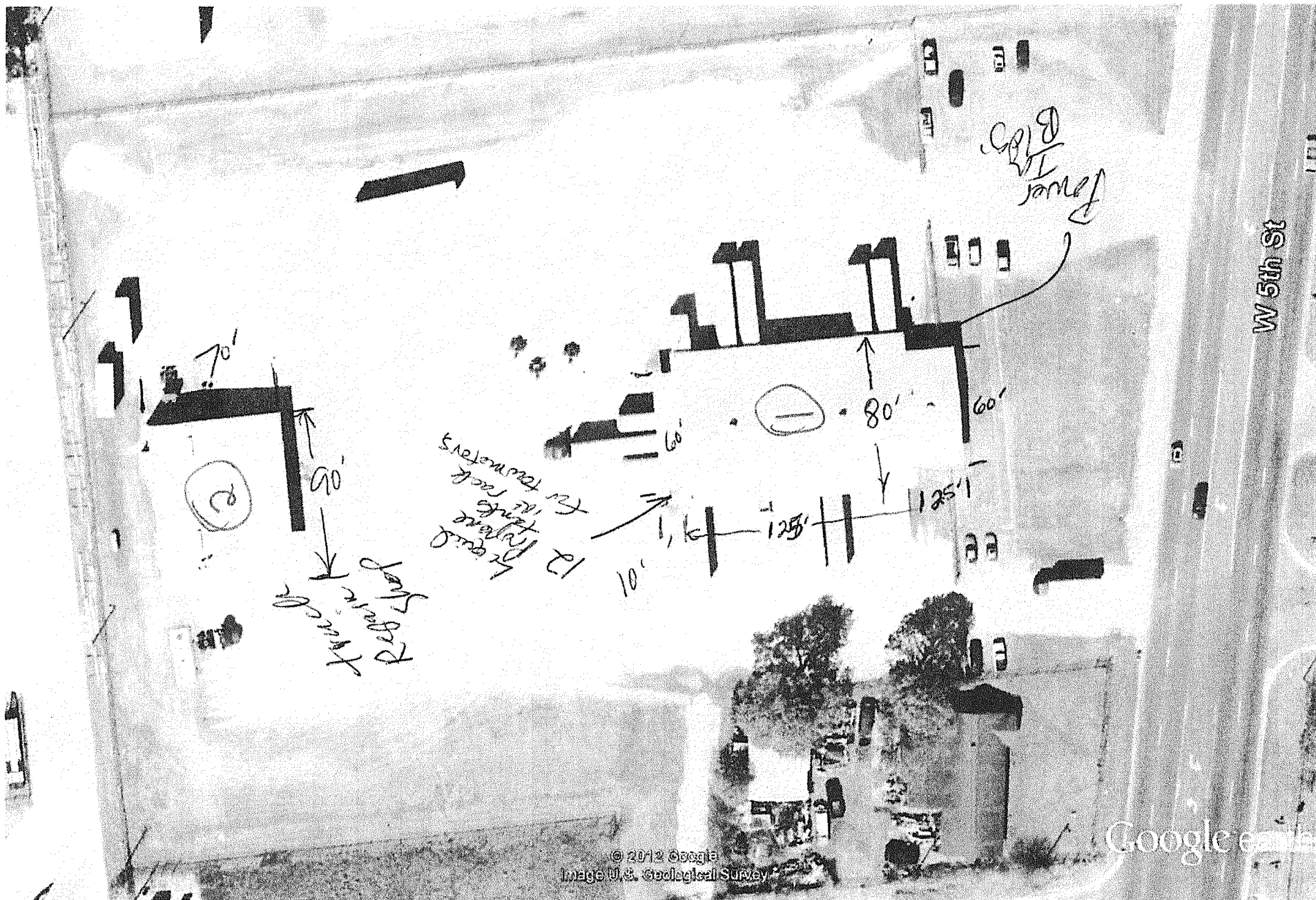

Google earth



AAA Cooper Transport.
2503 W 15th St.



Google earth

feet
meters



Structure Name

ACT

Terminal

Structure Address

2503 W 75th St.

Length	Width	Sq Ft	Sq Root	X 18	X construction type	GPM sum 1	X Occupancy	GPM sum 2
151.25	80	12100	110.00	1980.00	0.8	1584.00	0.75	#####

Column F
Fire Resistive 0.6
Non-combustible 0.8
Ordinary 1
Wood Frame 1.5

Column H
.75 if Mostly non-combustible contents
.85 if Limited combustibles (apartments, churches, schools, hospitals)
1.0 if Mostly combustible (restaurants, sheds, garages)
1.15 if Free burning contents (post offices, horse stables, feed mills, repair garages, ag storage)
1.25 if Rapid burning (aircraft hangers, tires, flammable liquids, wood working)

Exposure % add	Exposure add GPM	Exposure per side (75% max) Total Side A	Exposure per side 75% max Side B	Exposure per side 75% max Side C	Exposure per side 75% max Side D	Total GPM with exposures
25%	297.00	0	0	0	0	1188.00
19%	225.72				0	
14%	166.32					
9%	106.92					
75%	891.00	Total A, B, C, D				
	MAX	0				

Column J, K, L and M
If up to 10 feet add 25% per side
If 11 to 30 feet add 19% per side
If 31 to 60 feet add 14% per side
If 61 to 100 feet add 9% per side

Round off to nearest 250 GPM for flows less than 2500 GPM, the nearest 500 GPM over 2500 GPM

Total GPM with exposures	Add 50% for each floor above ground floor	# of floors	Total to add for floors above	Sub-total with floors added	If wood shingles on roof add 500 GPM
1250.00	625	0	0.00	1250.00	0
					1250.00

**FIRE FLOW NEEDED
GPM**

1250.00

Structure Name ACT - Maint Shop.
 Structure Address 2503 - W. 54th St.

Length	Width	Sq Ft	Sq Root	X 18	X construction type	GPM sum 1	X Occupancy	GPM sum 2
90	70	6300	79.37	1428.71	0.8	1142.96	1	#####

Exposure % add	Exposure add GPM	Exposure per side (75% max) Total Side A	Exposure per side 75% max Side B	Exposure per side 75% max Side C	Exposure per side 75% max Side D	Total GPM with exposures
25%	285.74	0	0	0	0	1142.96
19%	217.16				0	
14%	160.02					
9%	102.87					
75%	857.22	Total A, B, C, D				
MAX	0	Column J, K, L and M				

Column F
Fire Resistive 0.6
Non-combustible 0.8
Ordinary 1
Wood Frame 1.5

Column H
.75 if Mostly non-combustible contents
.85 if Limited combustibles (apartments, churches, schools, hospitals)
1.0 if Mostly combustible (restaurants, sheds, garages)
1.15 if Free burning contents (post offices, horse stables, feed mills, repair garages, ag storage)
1.25 if Rapid burning (aircraft hangers, tires, flammable liquids, wood working)

Round off to nearest 250 GPM for flows less than 2500 GPM, the nearest 500 GPM over 2500 GPM
If up to 10 feet add 25% per side
If 11 to 30 feet add 19% per side
If 31 to 60 feet add 14% per side
If 61 to 100 feet add 9% per side

Total GPM with exposures	Add 50% for each floor above ground floor	# of floors	Total to add for floors above	Sub-total with floors added	If wood shingles on roof add 500 GPM
1250.00	625	0	0.00	1250.00	0
					1250.00

FIRE FLOW NEEDED GPM
<u>1250.00</u>